

DIGITAL REC CARDS

You may use a smart phone app to store a virtual copy of your rec card. Please be aware, if there is ever an issue with your virtual card, the starter or monitor always has the right to require your real rec card. We highly recommend you continue to carry your regular rec card until you are sure you have the virtual card stored correctly, and your phone is scannable. (Screen protectors and brightness settings can affect the ability of the scanners to read certain phones).

Please note: Photographs of your rec card are not sufficient, cannot be read by our scanners and will not be accepted.

To add your rec card to your Apple (iOS) or Android device, you will need to sign into The Apple (iOS) APP STORE and/or the GOOGLE PLAYSTORE and download an app designed to store barcoded membership/loyalty cards. The Rec Centers will accept a variety of apps; basic requirements include storing the barcode in a scannable format, and storing a photographic backup of your card.

We do not recommend any particular app, and we do not provide support for the many apps available. But to aid residents who are using these digital cards for the first time, we have compiled instructions on a few examples below: KeyRing and Klarna. (If you previously used StoCard, it changed to Klarna in October 2024).

KeyRing App on Apple and Android

Step by step guide

1. Locate either the Apple App Store or the Google Play Store
2. Search for Key Ring



App Store



Google Play Store

3. Download the Key Ring App to your device.

From there, follow the instructions for either Apple or Android below:

– Apple (iOS)

4. Open the App
5. Accept/Deny App permission
6. Select Add/Link your first card
7. Select “Other Retailer Not Listed”
8. Description – Add a description for your RCSCW Card
9. You can either enter your Rec Card Number or select the small barcode icon to the right to use your phone camera to scan your rec card barcode.

A screenshot of the KeyRing app's 'Add Card' screen. The screen has a blue header with a back arrow on the left, the time '2:36', and LTE signal strength on the right. Below the header is a card icon and the text 'Other Retailer Not Listed'. There is a 'Description' field containing 'RCSCW'. Below that are two radio button options: 'Barcode' and 'Membership ID/Other'. A small barcode icon is visible to the right of the 'Barcode' option. At the bottom, there is a large blue 'Create' button and a smaller 'Cancel' button.

- a. Note: You will need to give this app permission to use your device camera to scan barcodes.
 - b. If you select to use your camera, place the barcode in screen view and hold it steady to scan your barcode.
10. Select "Create"
 11. The newly created Card will appear in the app.

Add Front image to your RCSCW Card

1. Select your RCSCW card from the list
2. Select "Front Image"
3. Next, tap on the center to take a photo of the front of the card.
4. Select "Take photo"
5. Align your card within the frame then press the Camera icon to take a photo of the front of the card.
6. Select "Done" after you capture the front of your card.
7. Select "Done" to go back to your card.

- Android

1. Open the App
2. Accept/Deny App permission
3. Select Add your First card
4. Select "Other Retailer Not Listed"
5. Description – Add a description for your RCSCW Card
6. Turn on the "Card has barcode" option.
7. You can either enter your Rec Card Number or select "Scan Card" to use the camera to scan your rec card barcode.
 - a. Note: You will need to give this app permission to use your device camera to scan barcodes.
 - b. If you select to use your camera, place the barcode in screen view and hold it steady to scan your barcode.
8. Select "Next"
9. On "Select Barcode Image", select the first option.
10. You can select "Card Front" to take a picture of the front of your card.
11. Select "Done" after you capture the front of your card.
12. Use the Back arrow to go back to your card.

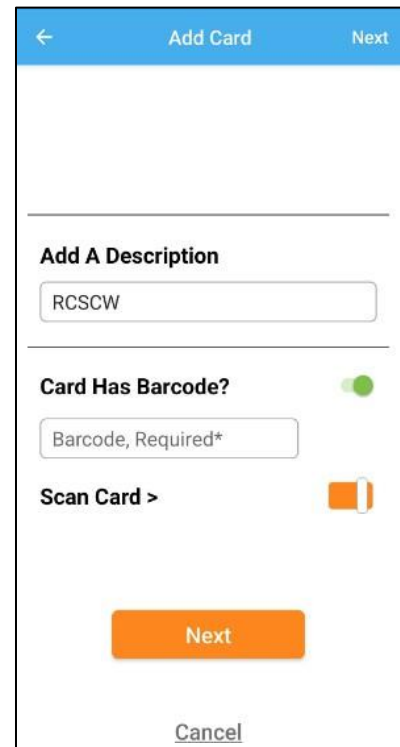

Any member who wishes to use Key Ring in place of their rec card must have the Front of card captured in the Notes tab. For use at SCW Golf Courses: The Front of card is required, and the Back of card is required if medical flag information is present.

Instructions on Migrating from StoCard to Klarna

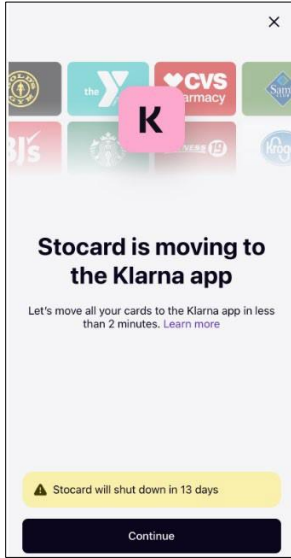

Open Stocard app

If you receive the prompt to move all your cards to Klarna, Click Continue

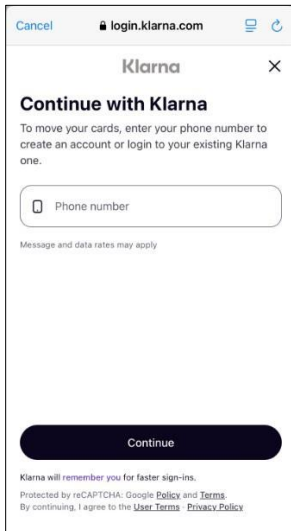

Enter your phone number to create an account. You will receive a text verification code, enter the verification code to proceed to the next step.

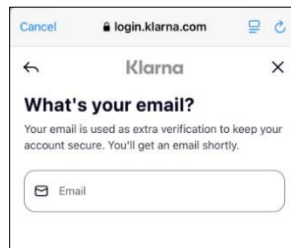

Enter an email which will be used as extra verification. You will receive an email verification code, enter the verification code to proceed to the next step.

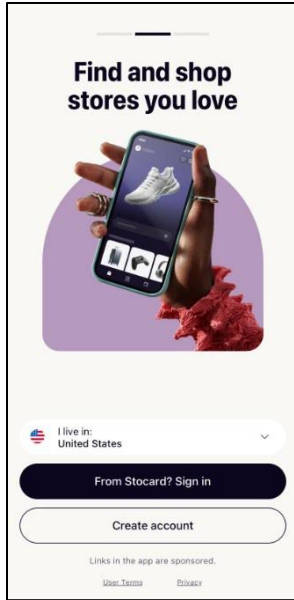

Download and Install the Klarna App

Open the Klarna App

Select “From Stocard?” Sign in.

You will receive the following popup, click Continue to share the log in information.

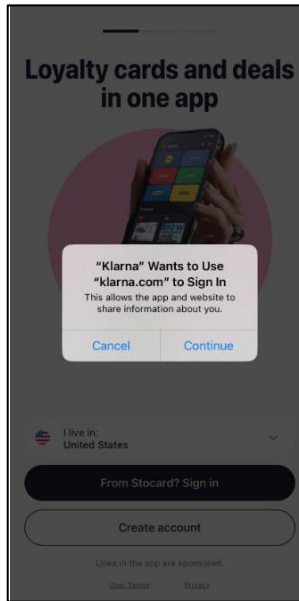

You will now be logged into Klarna.

Your cards should automatically migrate over from StoCard to Klarna. If they do, then you can skip these next steps. If they do not, you can add them again:

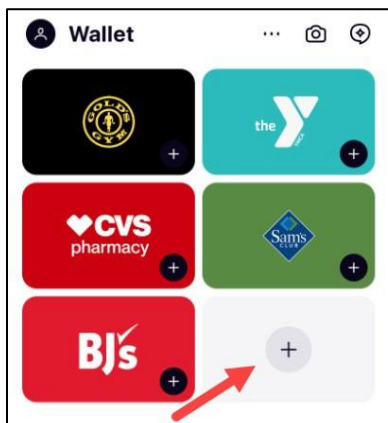

Click the empty “+” card

Scroll down and select “Other Card”

You will need to give this app permission to use your camera.

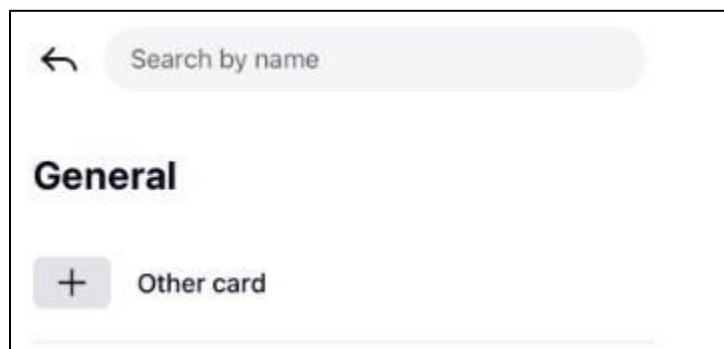

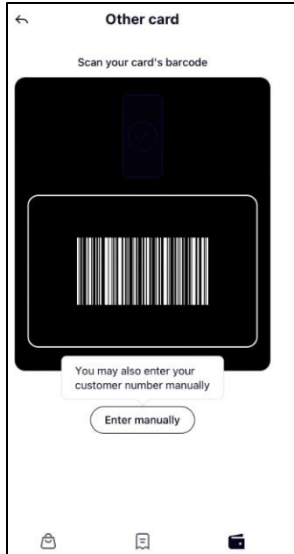

Scan your Rec Card barcode using your phone's camera.

Type in a name for your card under "store name". Click Add.

You can also add it manually by typing in the Rec Card number using the numbers on your phone.

Click the back arrow to return to your wallet. You will now see your Rec Card (a colored box representing a card).

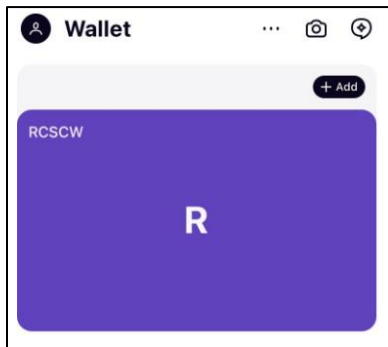

Click on the Rec Card, then click on "Photos"

Click on the camera icon/ "Add front photo"

Take picture of the front of your rec card and click "Use photo" to add the photographic backup to your digital rec card.

This completes the process

If you are not migrating from StoCard, but are using Klarna for the first time, please follow the above instructions beginning with **"Download and Install the Klarna App"**